

LOWRANCE®

TMR-1 REMOTE CONTROLLER USER GUIDE

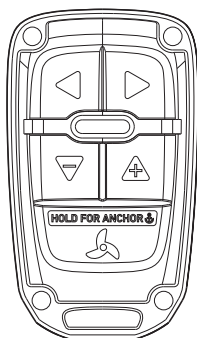

* 9 8 8 - 1 2 6 5 2 - 0 0 1 *

Compliance statements

Declarations

The relevant declarations of conformity are available at: www.lowrance.com

Europe

Navico declare under our sole responsibility that the product conforms with the requirements of:

- CE under RED 2014/53/EU

United States of America

Navico declare under our sole responsibility that the product conforms with the requirements of:

- Part 15 of the FCC Rules. Operation is subject to the following two conditions: (1) this device may not cause harmful interference, and (2) this device must accept any interference received, including interference that may cause undesired operation.



Warning: The user is cautioned that any changes or modifications not expressly approved by the party responsible for compliance could void the user's authority to operate the equipment.

→ **NOTE:** The equipment generates, uses and can radiate radio frequency energy and, if not installed and used in accordance with the instructions, may cause harmful interference to radio communications. However, there is no guarantee that the interference will not occur in a particular installation. If this equipment does cause harmful interference to radio or television reception, which can be determined by turning the equipment off and on, the user is encouraged to try to correct the interference by one or more of the following measures:

- Reorient or relocate the receiving antenna
- Increase the separation between the equipment and receiver
- Connect the equipment into an outlet on a circuit different from that of the receiver is connected
- Consult the dealer or an experienced technician for help

ISED Canada

This device complies with ISED (Innovation, Science and Economic Development) Canada's license-exempt RSSs. Operation is subject to the following two conditions: (1) This device may not cause interference; and (2) This device must accept any interference, including interference that may cause undesired operation of the device.

La traduction française de ce document est disponible sur le site Web du produit.

Australia and New Zealand

Navico declare under our sole responsibility that the product conforms with the requirements of:

- Level 2 devices of the Radiocommunications (Electromagnetic Compatibility) standard 2017
- Radiocommunications (Short Range Devices) Standards 2014

Parts included

- A. Remote controller
- B. AAA batteries, 2x
- C. Documentation
- D. Lanyard strap with carabiner clip
- E. Wrist strap

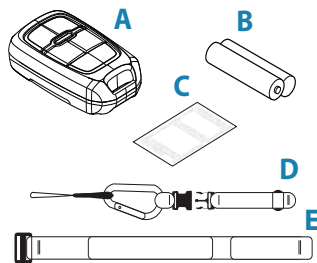

Technical specifications

Dimensions	H: 73 mm (2.87"), W: 42 mm (1.65"), D: 22 mm (0.87")
Power	2x AAA batteries
Temperature	Operating: -20°C to +55°C (-4°F to +131°F) Storage: -30°C to +70°C (-22°F to +158°F)
Humidity	66°C, 95% RH, 18 hrs
IP code	IPx6, IPx7
Communication	Bluetooth, range ~30 m (98 ft)

Operation

Keys

Description	
A	Left and Right steering Anchor mode: moves anchor position 1.5 m (5 ft) left or right
B	LED
C	Propeller speed Up and Down Anchor mode: moves anchor position 1.5 m (5 ft) forward or backward
D	Single press: propeller ON/OFF Press and hold: activates Anchor mode

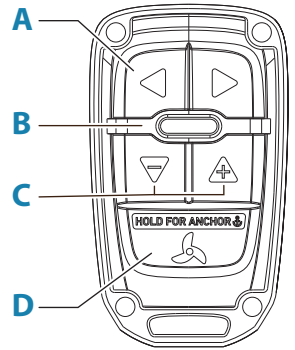

Pair and configure the remote

1. Insert the batteries in the TMR-1
2. Put TMR-1 into discoverable mode by holding propeller speed Up and Down (**C**) keys at the same time for at least 5 seconds. The LED (**B**) should flash red in 1 second intervals
3. Put the trolling motor into user configuration mode by holding the configurable key 2 and configurable key 3 on the pedal until an audible tone is heard and the Power LEDs start blinking. Next, press and hold the Battery test key. An audible tone will be heard and the battery status LEDs will start blinking when the trolling motor is in Bluetooth pairing mode.
4. Once the LED on the TMR-1 starts blinking in green, press and hold propeller ON/OFF (**D**) key. When the green LED changes to long flashing, TMR-1 is paired to the trolling motor
5. Exit configuration mode on the trolling motor (alternatively power cycle the trolling motor)

TMR-1 can now be used to control the trolling motor.

LED behavior

Color	Behaviour	Status
Red	Slow flashing	Low battery
	Fast flashing (1s intervals)	In pairing mode
	Flash (on key press)	Not connected
Green	Flash (on key press)	Connected and working

Add/replace batteries

The unit uses 2x AAA batteries.

Remove the cover to add or replace batteries.

